

THE ROXBURY BARN & ESTATE

Property Map and Floor Plans



THE ROXBURY
BARN & ESTATE

PROPERTY MAP

THE ROXBURY
BARN & ESTATE

667 County Highway 41, Roxbury, NY 12474
telephone (607) 326-4874
theroxburybarn.com

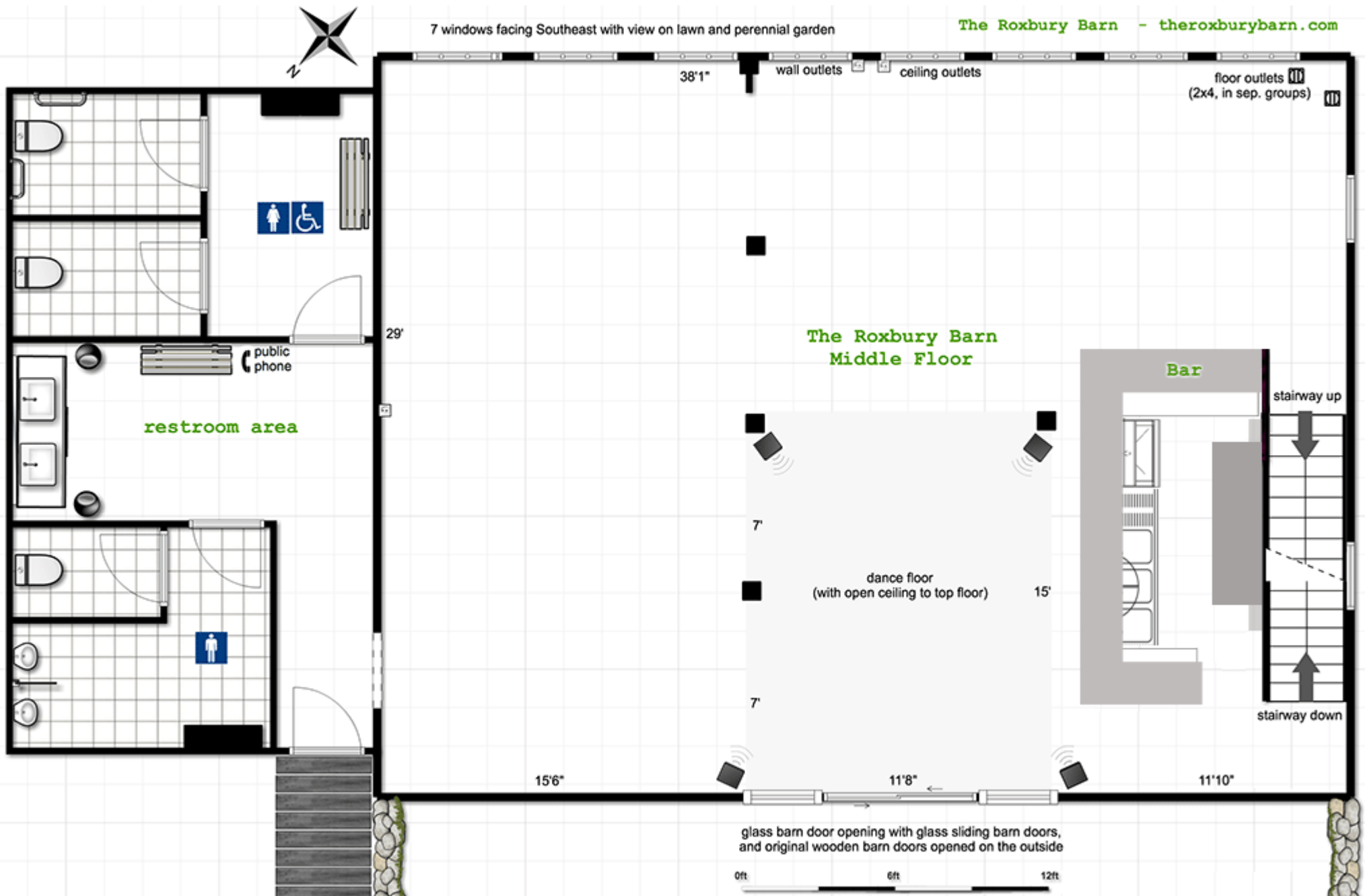

Our 166-year old carriage barn is built against a cliff, with the lower floor only exposed on the backside. The event spaces in the barn are on the middle and top floor. The middle floor opens up to a tree-lined lawn with a lily pond, through two large barn doors and a spectacular glass facade. The bar and the restrooms are also located on the middle floor. The two upper floors of The Roxbury Barn & Estate together seat up to 140 persons for dinner.

7 windows facing Southeast with view on lawn and perennial garden

The Roxbury Barn - theroxburybarn.com

A selection
of our many suggested
seating arrangements:

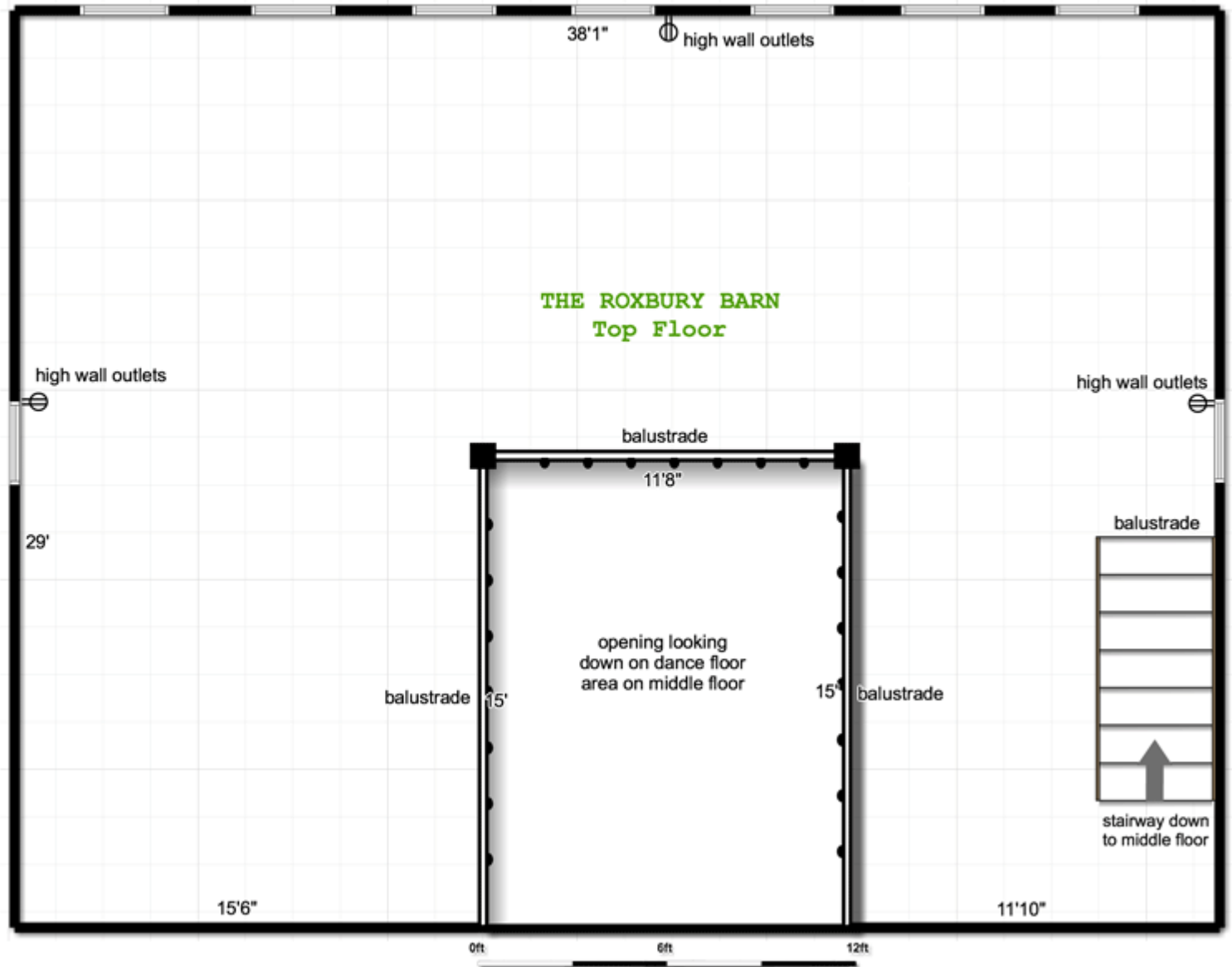

The top floor of the barn seats a maximum of 100 persons. For parties over 100 persons, we recommend seating two-thirds of your party on the top floor, and one-third on the middle floor. An event booking at The Roxbury Barn & Estate comes with floor plans with a wide range of seating arrangement suggestions.

THE RESTROOMS

THE BARN

The Captain's House
& Shuttle Buses

walking bridge

stone wall

stone wall

KEEP OPEN SPACE FOR CART TRAFFIC

Flower bed with stone wall

SMALL PAVILION

Pavilion, Parking,
& Pine Grove

Floor plan for the graveled courtyard
in front of the barn, with a suggested seating
arrangement for approx. 116 guests (which can
easily be extended or reduced).

